

OSNOVA STANA

3D PRIKAZ STANA

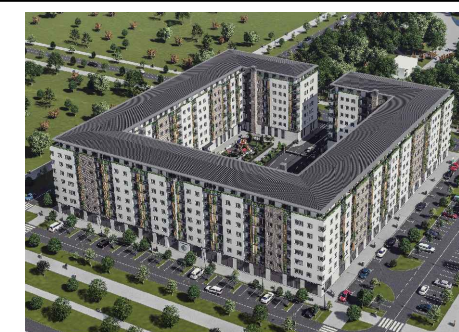

ZGRADA

L6

STAN

6.3

SOBNOST

DVOSOBAN

SPRATOVI

I, II, III, IV, V, VI

POVRŠINA

36,67 m²



PARKNOVI
RESIDENCE



SITUACIONI PLAN

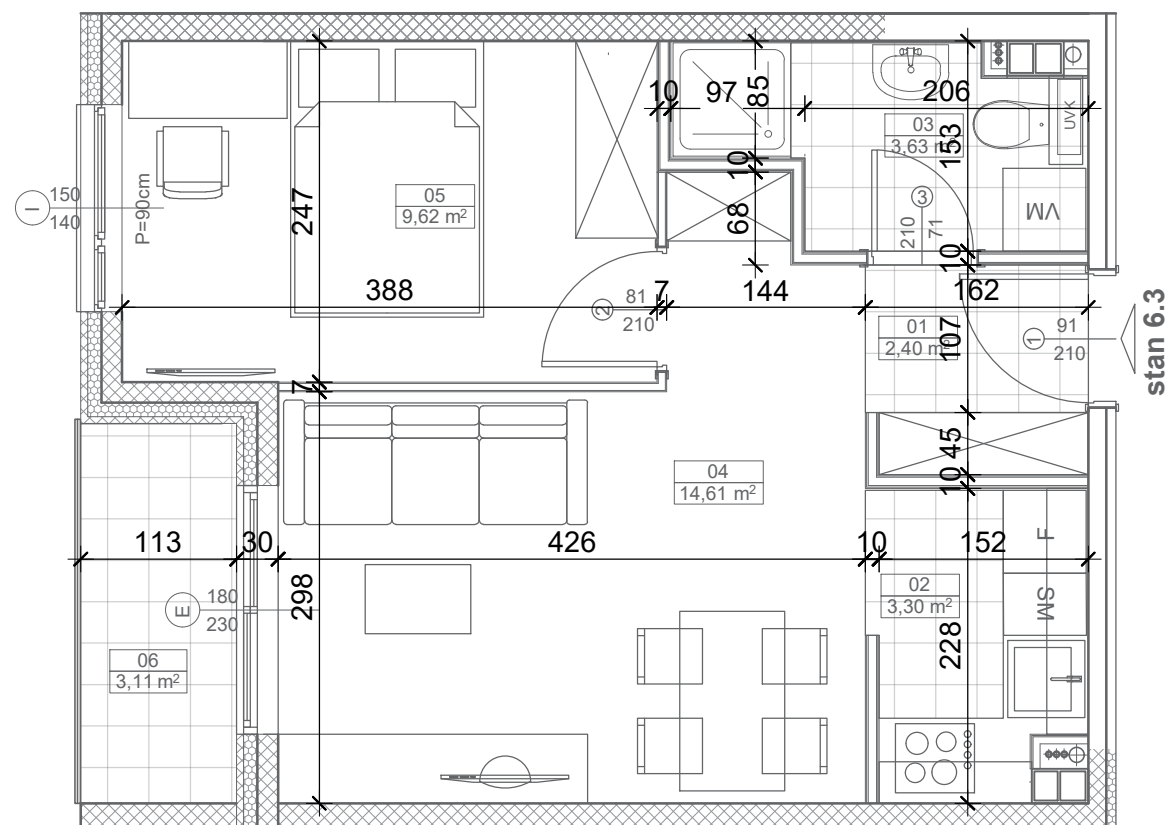
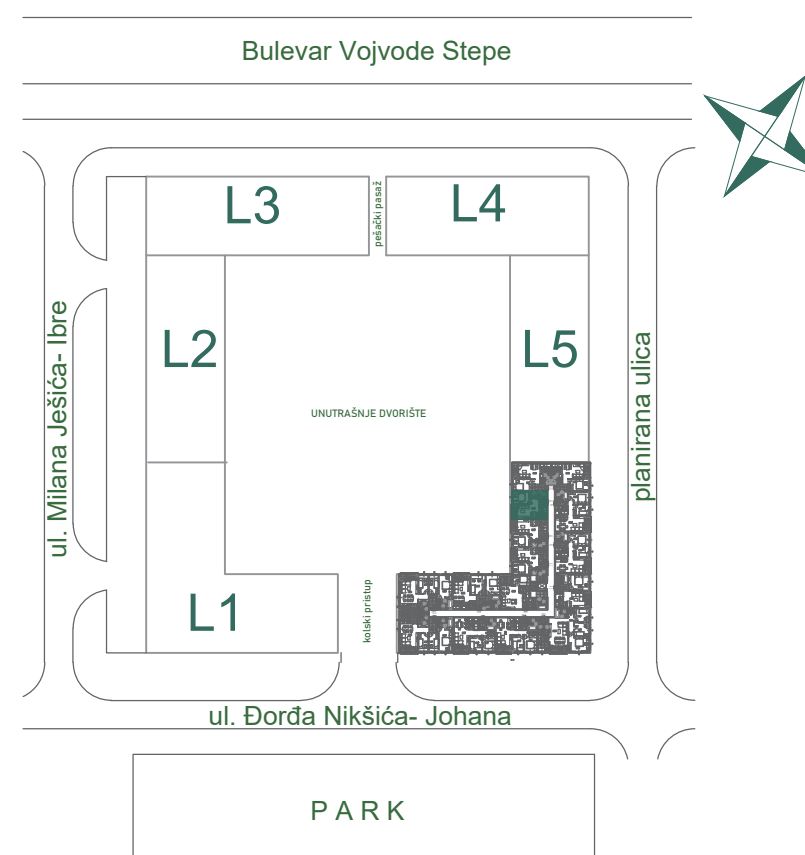

POVRŠINE

Broj	Prostorija	Površina	Redukovana površina (m ²)
01	Predsooblje	2,40	2,40
02	Kuhinja	3,35	3,30
03	Kupatilo	3,74	3,63
04	Dnevni boravak	14,61	14,61
05	Soba	9,62	9,62
06	Lođa	3,11	3,11
NETO		36,83 m ²	36,67 m ²