

## OSNOVA STANA

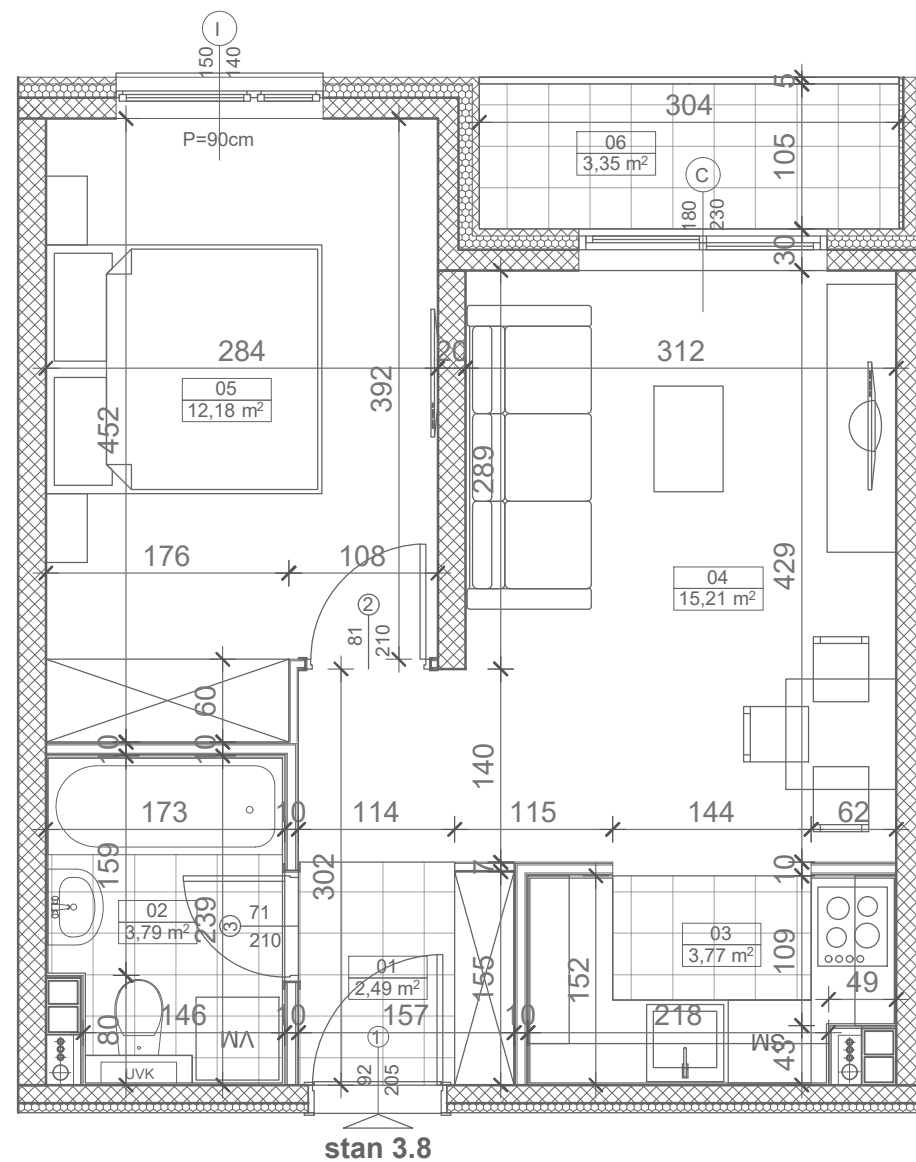

stan 3.8

## POVRŠINE

Broj	Prostorija	Površina	Redukovana površina (m2)
01	Predsjoblje	2,49	2,49
02	Kupatilo	3,91	3,79
03	Kuhinja	3,83	3,77
04	Dnevni boravak	15,21	15,21
05	Spavaća soba	12,18	12,18
06	Lođa	3,35	3,35
NETO		40,97 m <sup>2</sup>	40,79 m <sup>2</sup>

## 3D PRIKAZ STANA



## SITUACIONI PLAN

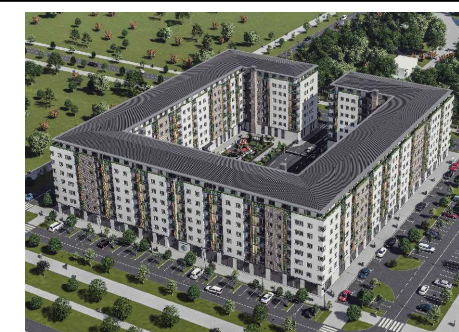
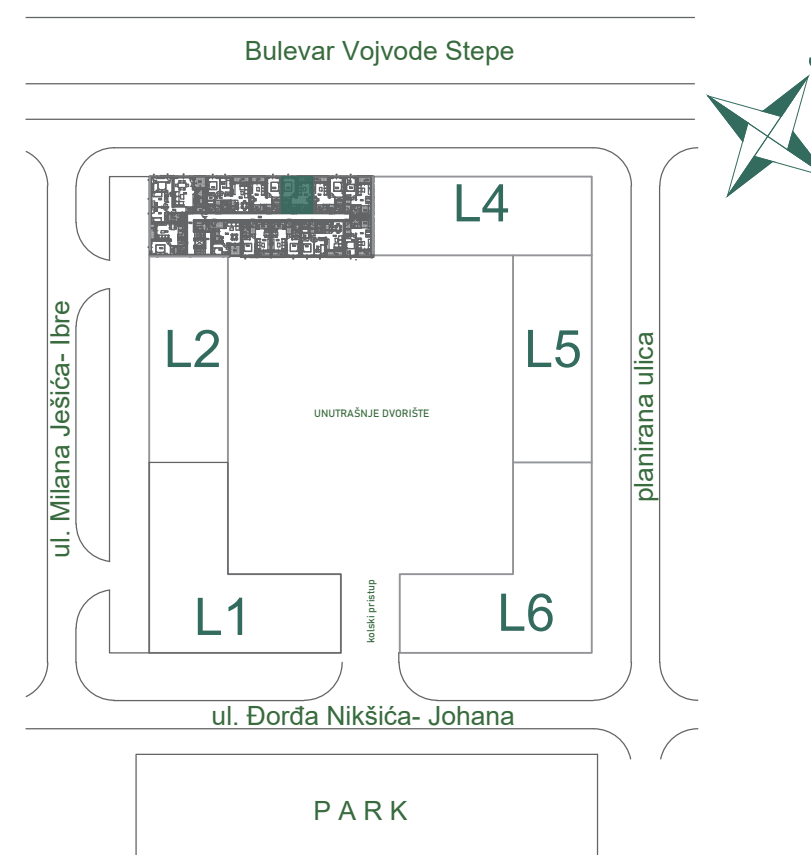

ZGRADA

**L3**

STAN

**3.8**

SOBNOST  
**DVOSOBAN**

SPRATOVI  
**I, II, III,  
IV, V, VI**

POVRŠINA

**40,79 m<sup>2</sup>**

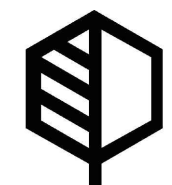

**PARKNOVI**  
RESIDENCE