

## OSNOVA STANA

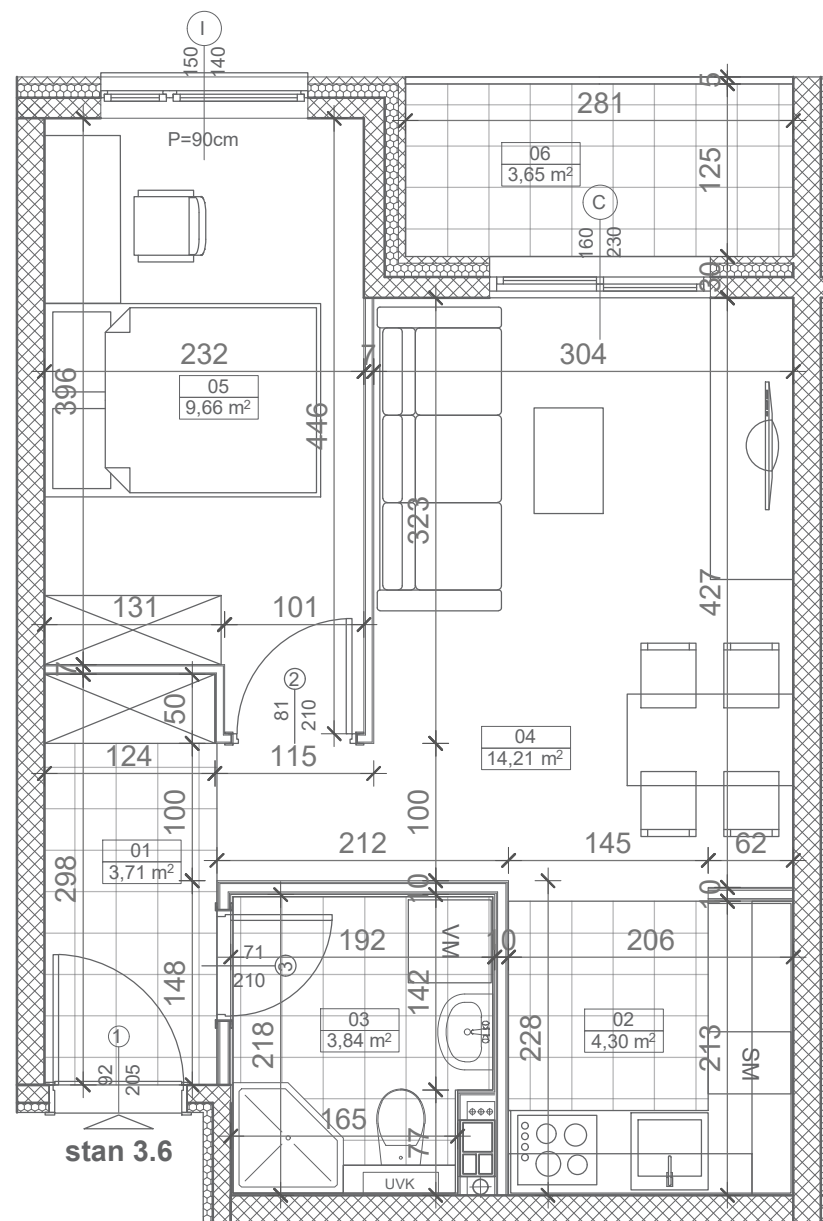

## POVRŠINE

Broj	Prostorija	Površina	Redukovana površina (m2)
01	Predsooblje	3,71	3,71
02	Kuhinja	4,37	4,30
03	Kupatilo	3,96	3,84
04	Dnevni boravak	14,21	14,21
05	Soba	9,66	9,66
06	Lođa	3,65	3,65
NETO		39,56 m <sup>2</sup>	39,37 m <sup>2</sup>

## 3D PRIKAZ STANA



## SITUACIONI PLAN

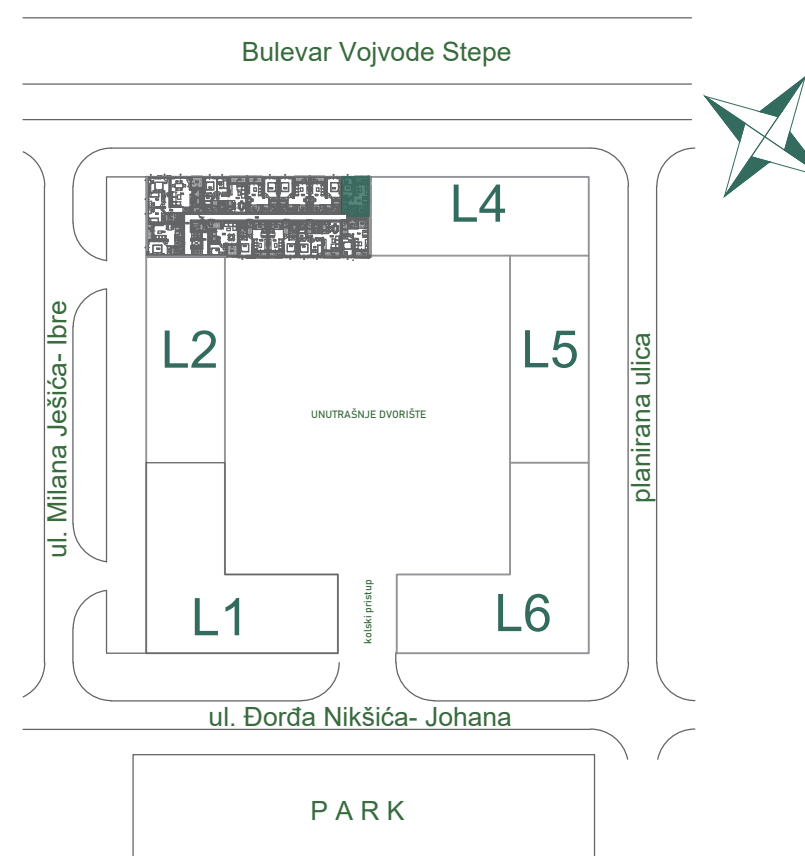

ZGRADA

**L3**

STAN

**3.6**

SOBNOST

**DVOSOBAN**

SPRATOVI

**I, II, III,  
IV, V, VI**

POVRŠINA

**39,37 m<sup>2</sup>**

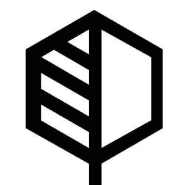

**PARKNOVI**  
RESIDENCE