

OSNOVA STANA

3D PRIKAZ STANA

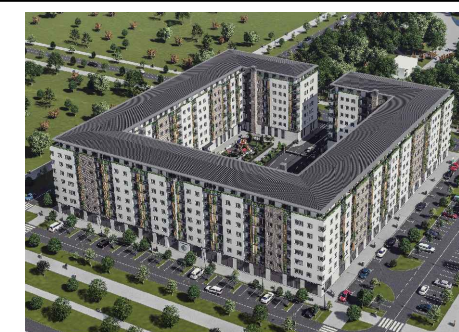

ZGRADA

L2

STAN

2.65

SOBNOST
ČETVOROSOBAN

SPRATOVI
VII
(PENTHOUSE)

POVRŠINA

99,85 m²



PARKNOVI
RESIDENCE

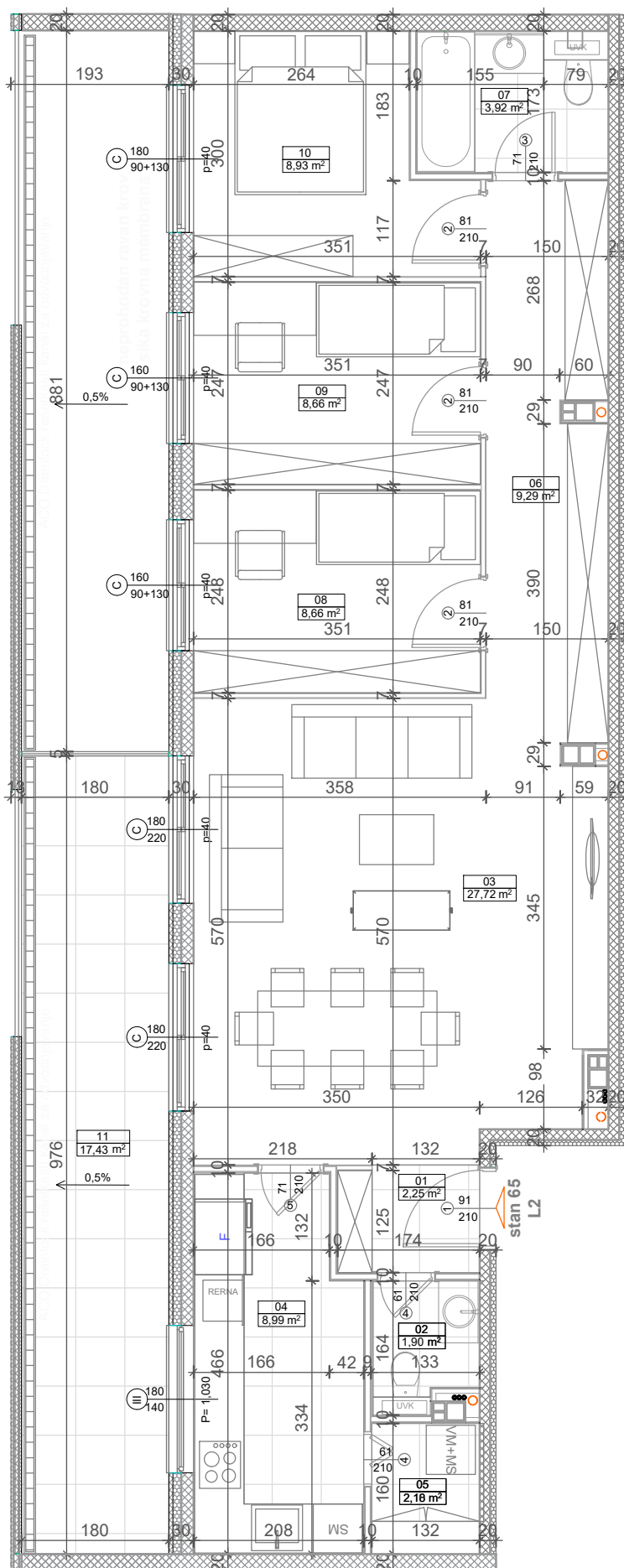

POVRŠINE

Broj	Prostorija	Površina	Redukovana površina (m ²)
01	Ulaz /Pedsoblje	2,25	2,25
02	Toalet	1,96	1,90
03	Dnevni boravak	27,72	27,72
04	Kuhinja	9,13	8,99
05	Ostava/vešernica	2,10	2,10
06	Degažman	9,29	9,29
07	Kupatilo	4,04	3,92
08	Soba	8,66	8,66
09	Soba	8,66	8,66
10	Soba	8,93	8,93
11	Terasa	17,43	17,43
NETO		100,17 m ²	99,85 m ²

SITUACIONI PLAN



Bulevar Vojvode Stepe

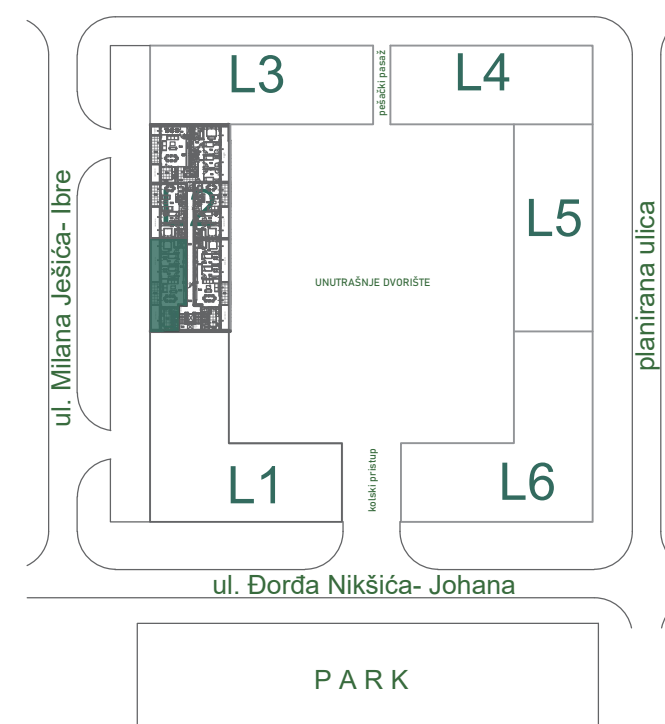

PARK