

OSNOVA STANA

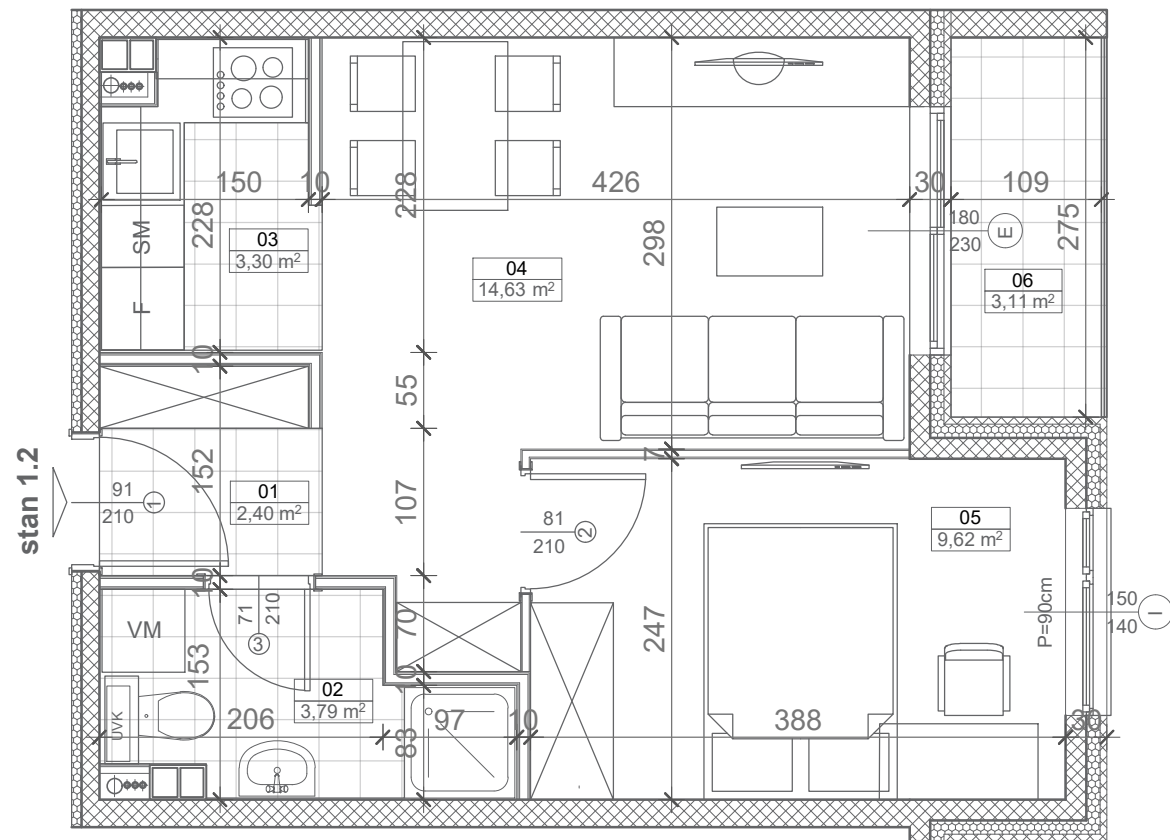

POVRŠINE

Broj	Prostorija	Površina	Redukovana površina (m2)
01	Predsoblje	2,40	2,40
02	Kupatilo	3,91	3,79
03	Kuhinja	3,35	3,30
04	Dnevni boravak	14,63	14,63
05	Soba	9,62	9,62
06	Lođa	3,11	3,11
NETO		37,02 m ²	36,85 m ²

3D PRIKAZ STANA



SITUACIONI PLAN

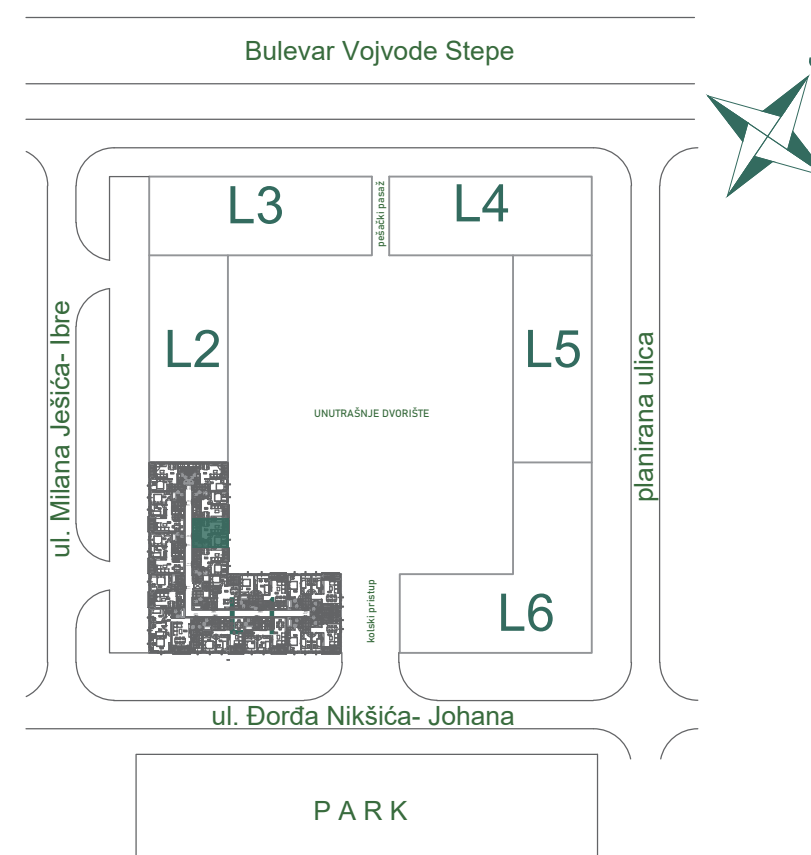

ZGRADA

L1

STAN

1.2

SOBNOST

DVOSOBAN

SPRATOVI

I, II, III,
IV, V, VI

POVRŠINA

36,85 m²

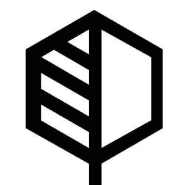

PARKNOVI
RESIDENCE