

OSNOVA STANA

3D PRIKAZ STANA

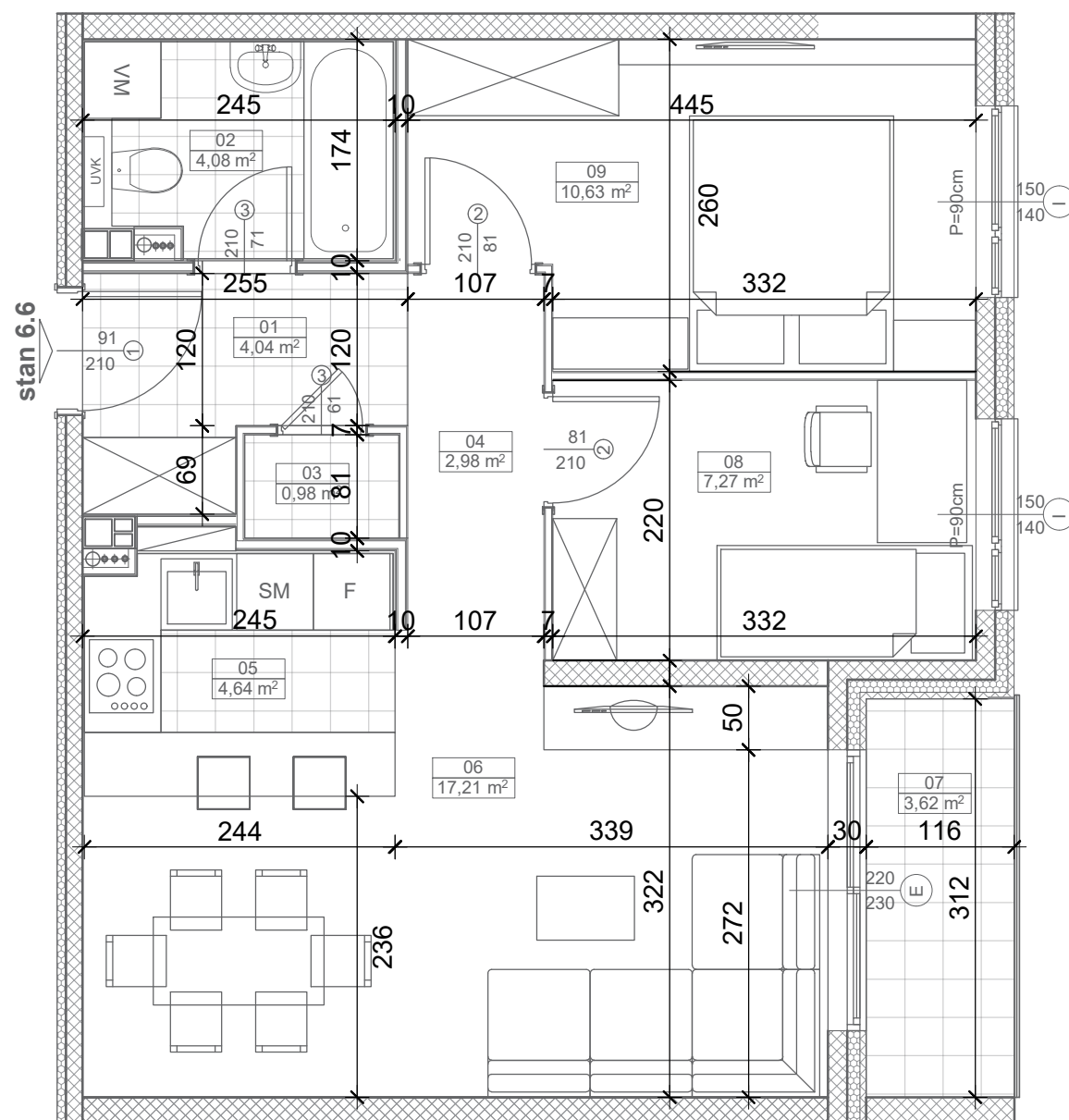
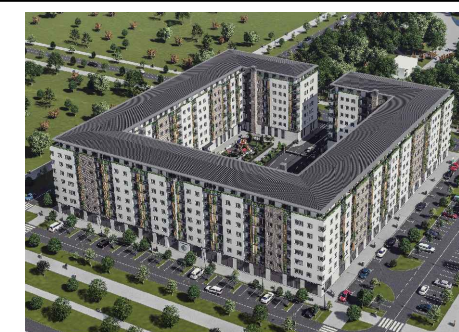

ZGRADA

L6

STAN

6.6

SOBNOST

TROSOBAN

SPRATOVI

I, II, III, IV, V, VI

POVRŠINA

55,45 m²

POVRŠINE

| Broj | Prostorija | Površina | Redukovana površina (m ²) |
|------|----------------|----------------------|---------------------------------------|
| 01 | Predsoblje | 4,04 | 4,04 |
| 02 | Kupatilo | 4,20 | 4,08 |
| 03 | Ostava | 0,98 | 0,98 |
| 04 | Hodnik | 2,98 | 2,98 |
| 05 | Kuhinja | 4,71 | 4,64 |
| 06 | Dnevni boravak | 17,21 | 17,21 |
| 07 | Lođa | 3,62 | 3,62 |
| 08 | Soba | 7,27 | 7,27 |
| 09 | Soba | 10,63 | 10,63 |
| NETO | | 55,64 m ² | 55,45 m ² |

SITUACIONI PLAN

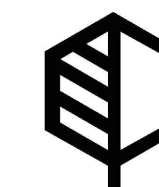
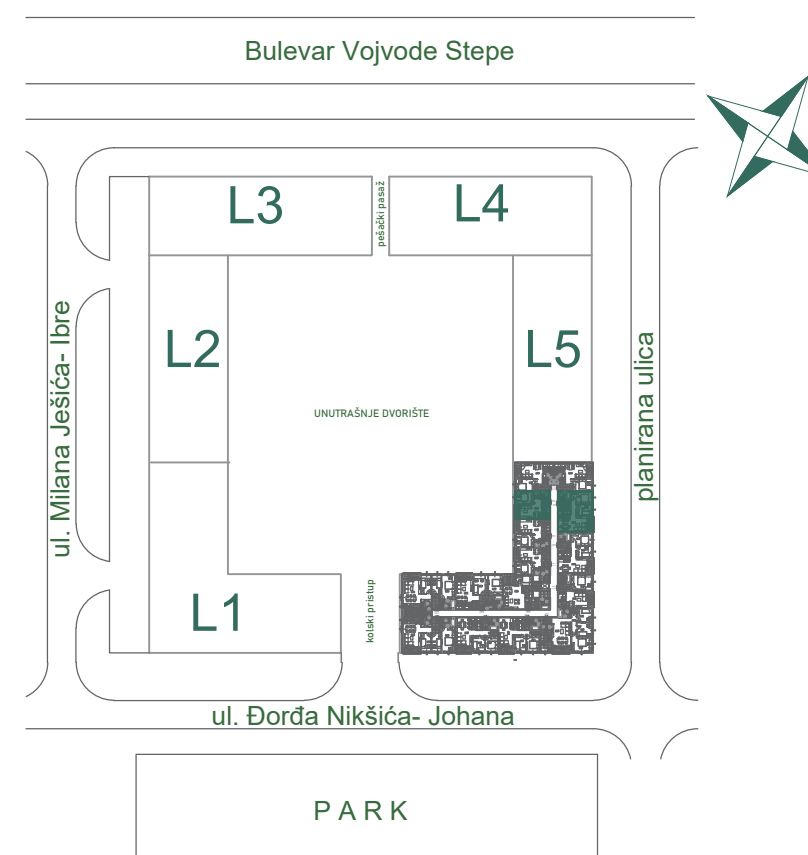

PARKNOVI
RESIDENCE